



Woodsmith **PLANS**

ROUTER BIT STORAGE CENTER



ROUTER BIT STORAGE CENTER

Keep your collection of accessories and router bits front and center with this easy-to-build weekend project.

For the longest time, it wasn't unusual to find router accessories tucked away in every corner of my shop. After spending more time looking for router bits than actually using them, I decided to get organized. So, I built this storage cabinet. It keeps all my bits and accessories protected and right at hand.

SMALL PROJECT, BIG FEATURES. The storage center has a number of handy features. For starters, there are three removable shelves for router bits. You can take the entire shelf right where you need to work — whether that's at a router table or across the shop at your workbench (with a hand-held router).

To ensure that you'll be able to store any size or shape router bit, there are two shelf designs. The drawings on the next page show the hole arrangement I used. But you can make whatever combinations of shelves, holes, and patterns you need to suit the bits you have.



▲ **Custom Shelves.** You can customize the shelves to suit your set of router bits. And each shelf slides in and out with ease so you can take it right where you need it.



EXPLODED VIEW
OVERALL DIMENSIONS:
28"H x 16"W x 4³/₈"D

NOTE: STORAGE CENTER MOUNTS TO WALL BY SCREWING THROUGH BACK

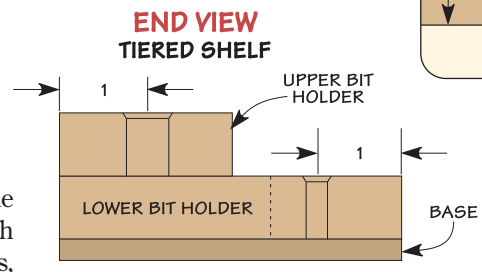
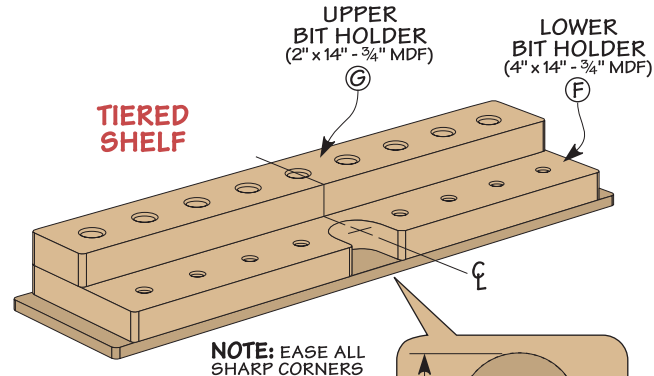
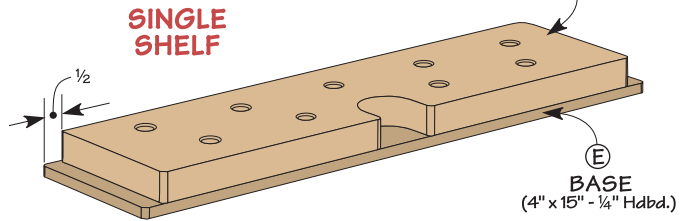
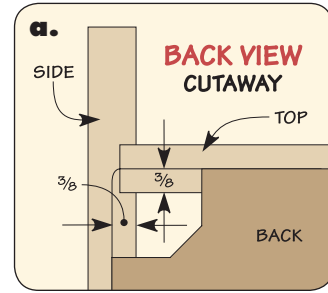
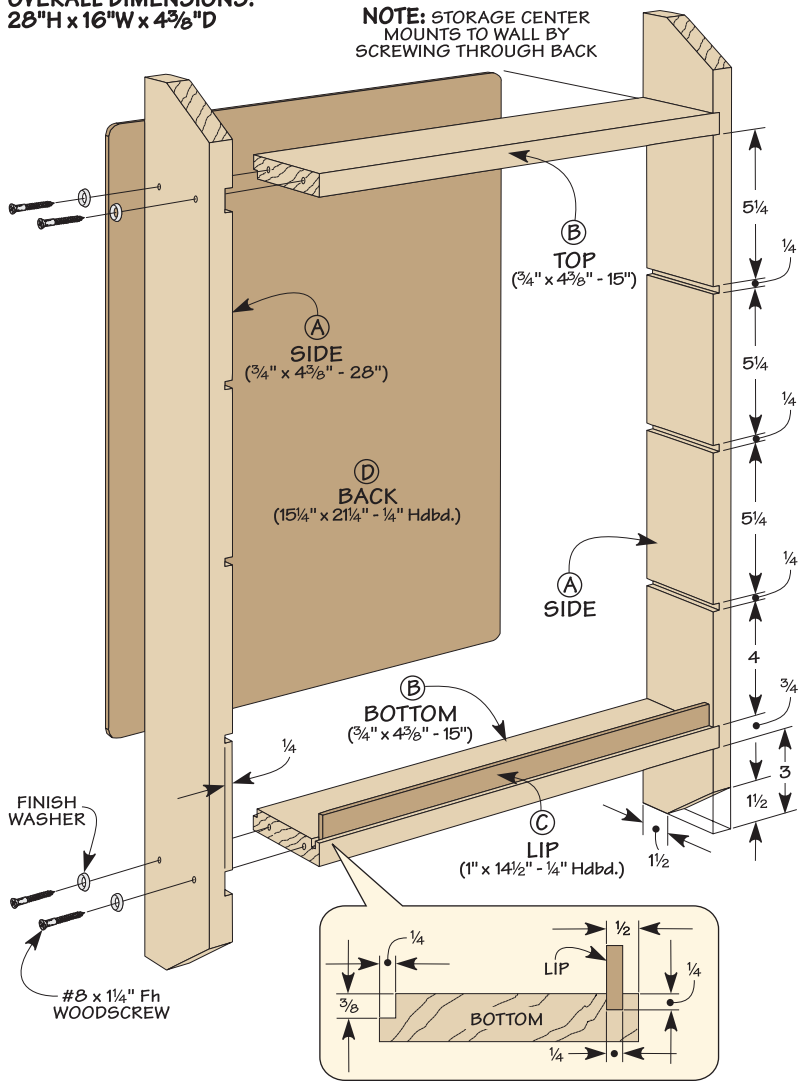

Finally, you don't want to lose track of all your router odds and ends, like wrenches and collets. To solve that problem, the bottom shelf has a hardboard lip to keep everything neatly contained.

MAKE THE FRAME. Start on the storage center by making a hardwood frame. As you can see in the Exploded View, it's nothing more than a pair of sides, along with a top and bottom. Dadoes cut near the ends of the sides are sized to match the top and bottom. And a set of narrower dadoes (1/4") will hold the shelves made later.

After finishing all the dadoes, you'll want to bevel the top and bottom of the sides to ease the sharp edges. Then, cut a groove along the front edge of the bottom piece to accept the hardboard lip.

Now that you've completed the joinery, assemble the frame with glue, screws, and finish washers, making sure the assembly is square.

To prevent racking, add a 1/4" hardboard back. As shown in detail 'a,' you'll rout a rabbet along the inside back edge of the frame. After cutting the back to size, round off the corners and glue the back in place.

SHELVES. At this point, you can make the shelves that hold the bits. Each shelf is nothing more than a 1/4" hardboard base with a single or double layer of MDF making up each bit holder.

But before you cut the shelves to size or drill any holes, get all your router bits together. This way, you can use the drawings above and your collection of router bits to

determine the best way to customize the shelves to suit your needs.

Once you have the holes laid out, drill them slightly oversized (1/32"). Then, chamfer the top edge so the shanks slip in and out easily (or sand the holes a bit after drilling them out). Before gluing the bit holders to the base, cut a centered notch to provide a convenient way to pull the shelf out (lower photo on page 1).

FILL IT UP. To mount the storage center to the wall, you can simply drive screws through the back. Now all that's left to do is fill the storage center with all your router bits and accessories.